

LEADWORK:
 Install lead soakers flashings etc. as shown to be as follows:
 Soakers code 3
 Flashings code 4
 All leadwork at abutments to have min 150mm upstands being wedged and tucked into a raked out 10mm slot in external brickwork.

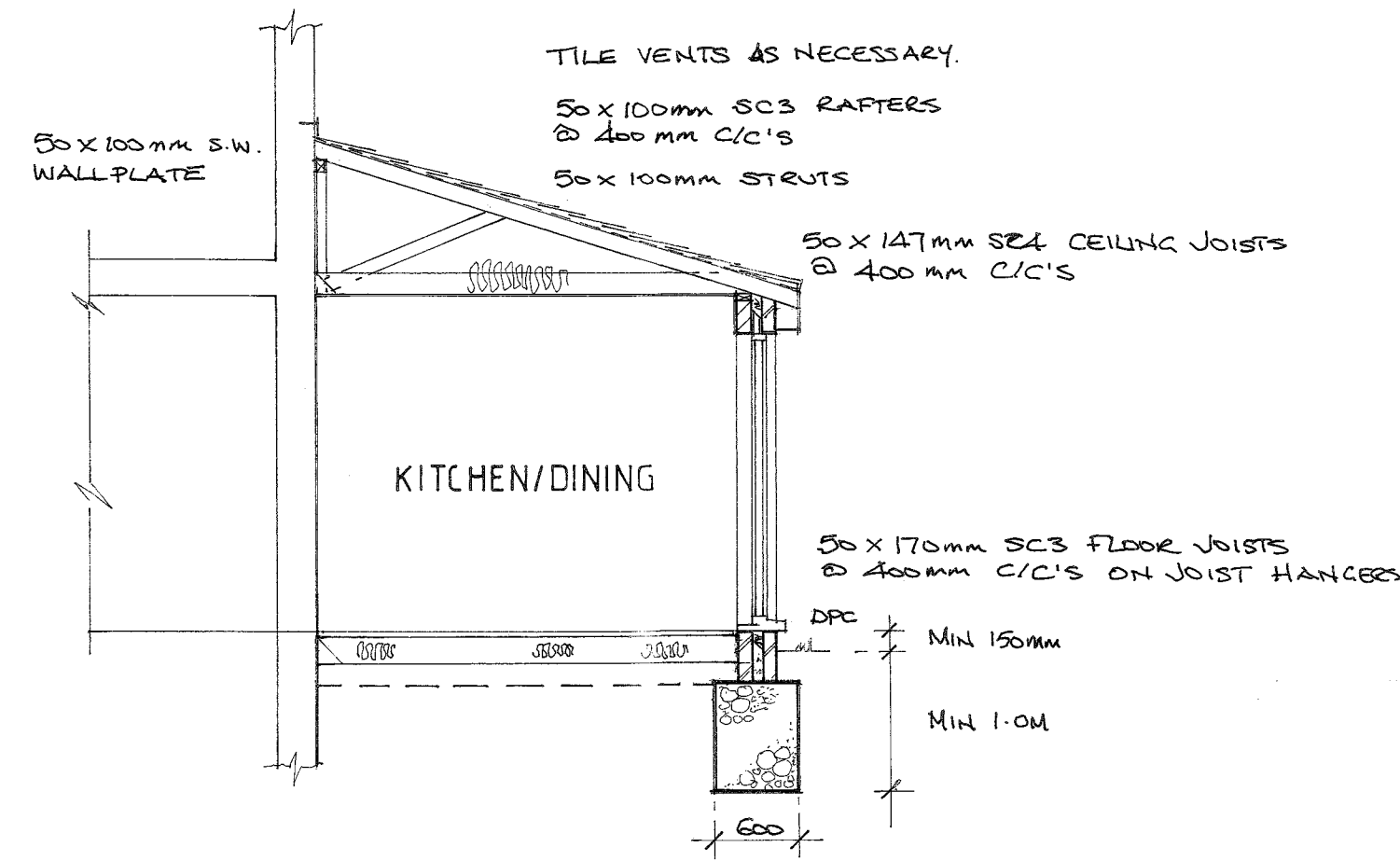

SECTION A - A

FOUNDATIONS:

Grade Gen 3 mass concrete trench fill foundations, min 1000mm deep, 600 mm wide all in strict accordance with Structural engineers details and the requirements of the Local Authority. Refer to drawing 07/83/05 for foundation plan.

BRICKWORK BELOW GROUND TO DPC:

Calcium silicate or similar approved common brickwork to be laid below ground in 1:6 cement sand mortar, with facing brickwork commencing 2 courses below ground and taken to dpc level. Cavities to be filled with concrete to 150mm below dpc with top sloping 45 degrees outwards.

GROUND FLOOR CONSTRUCTION:

22mm flooring grade t&g chipboard to BS5669. Moisture resistant grade to kitchen, with staggered cross joints all glued together with a 10mm gap around the perimeter, on 50 x 170mm s.w floor joists at 400mm centres with 110mm celotex laid between all to manufacturers details with a 150mm void under, 1200 gauge polythene vapour barrier, weighted down with sand on subsoil after removal of any top soil or vegetation, perimeters to lap with dpc's. Airbricks with telescopic vents at 2m c/c to ventilate sub floor void.

EXTERNAL WALL CONSTRUCTION:

Generally 285mm overall wall construction. Walls are 102.5mm brickwork outer leaf to match with existing, 85mm cavity, closed with proprietary insulated cavity closers, completely filled with Rockwool or similar approved cavity insulation batts and Thermalite Shield 2000 blockwork or similar approved inner leaf with 13mm lightweight plaster finish. Provide Catnic or similar austenitic stainless steel wall ties at 900mm horizontal and 450mm vertically staggered centres and to all reveals at 300mm vertical centres. All brickwork and blockwork to be laid in 1:1.6 mortar.

HORIZONTAL DPC:

Provide and install pitch polymer or similar dpc 150mm above ground level, with minimum 100mm laps.

BELOW GROUND DRAINAGE:

Provide new back inlet gully & connect to existing inspection chamber via 110mm dia. Upvc underground pipes laid to falls of 1 in 60 (foul) 1 in 100 (surface water) New foul drain runs connected into existing system as shown.

Underground pipes outside of building are to be bedded on and surrounded with min. 150mm of pea shingle beneath garden areas and 150mm C20p concrete bed and surround where pipes run within 300mm of the building or are within 450mm beneath roads & drives). Provide lintel protection over pipes passing through foundation or brickwork. All Upvc underground pipework to comply with BS4660/5481 and to be Marley Extrusions or similar and to be installed in strict accordance with manufacturers instructions.

Surface water drains connected to 1metre cube soakaway, sized below lowest incoming invert, soakaways to be filled with clean brick rubble hardcore and covered with 1200 gauge polythene prior to reinstatement of top soil. Located min 5.0m from any buildings/highway.

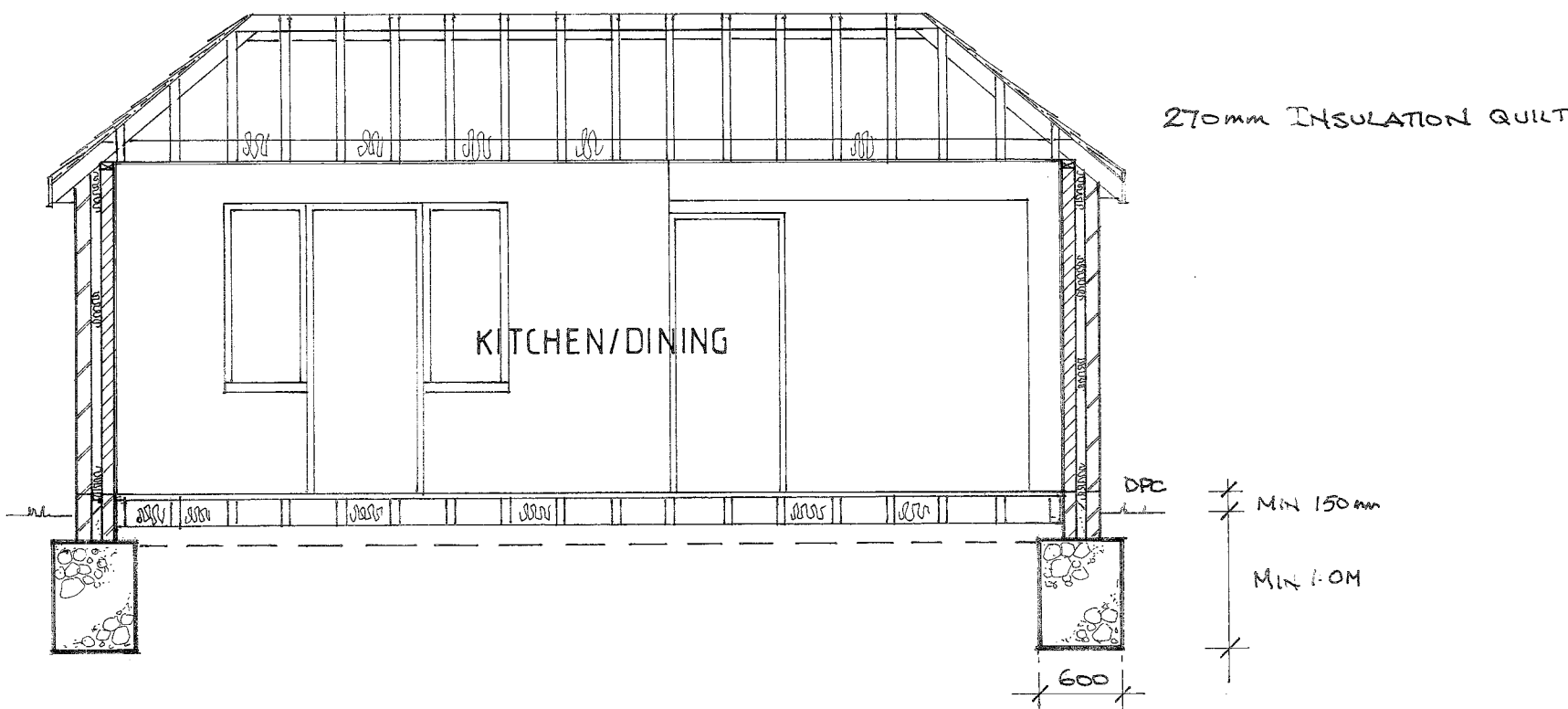

SECTION B - B

ROOF CONSTRUCTION:

Roof to be 50 x 100mm rafters at 400mm centres onto 100 x 50mm tanalised wall plates bedded on top of inner leaf of cavity walls. Plates secured with 30 x 5mm x 1000 mm long galvanised steel vertical restraint straps by Catnic or similar at 1800mm centres, fixed to plate and turned down face of wall. All structural timber to be Grade SC3

Roof to be covered with tiles to match existing laid in strict accordance with manufacturers instructions on 38x25mm tanalised softwood battens, all on sarking felt to BS747 dressed down into gutter. Provide and lay 100mm mineral wool insulation quilt between ceiling joists, with a further 170mm mineral wool insulation laid across to give 270mm total thickness.

500g polythene vapour barrier to be tacked to underside of ceiling joists before plasterboard ceilings are installed.

Fascia boards to be 25mm softwood, with 25mm continuous ventilated soffit, Rytons Clip strip or similar and 6mm masterboard or similar soffit board.

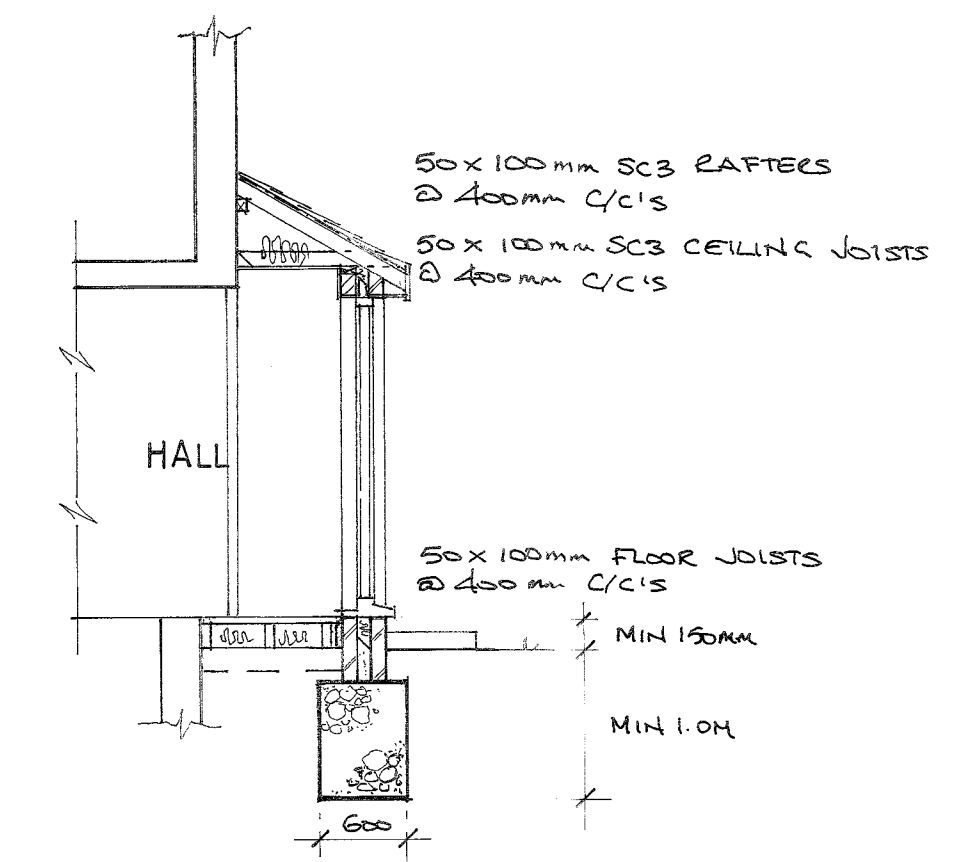

SECTION C - C

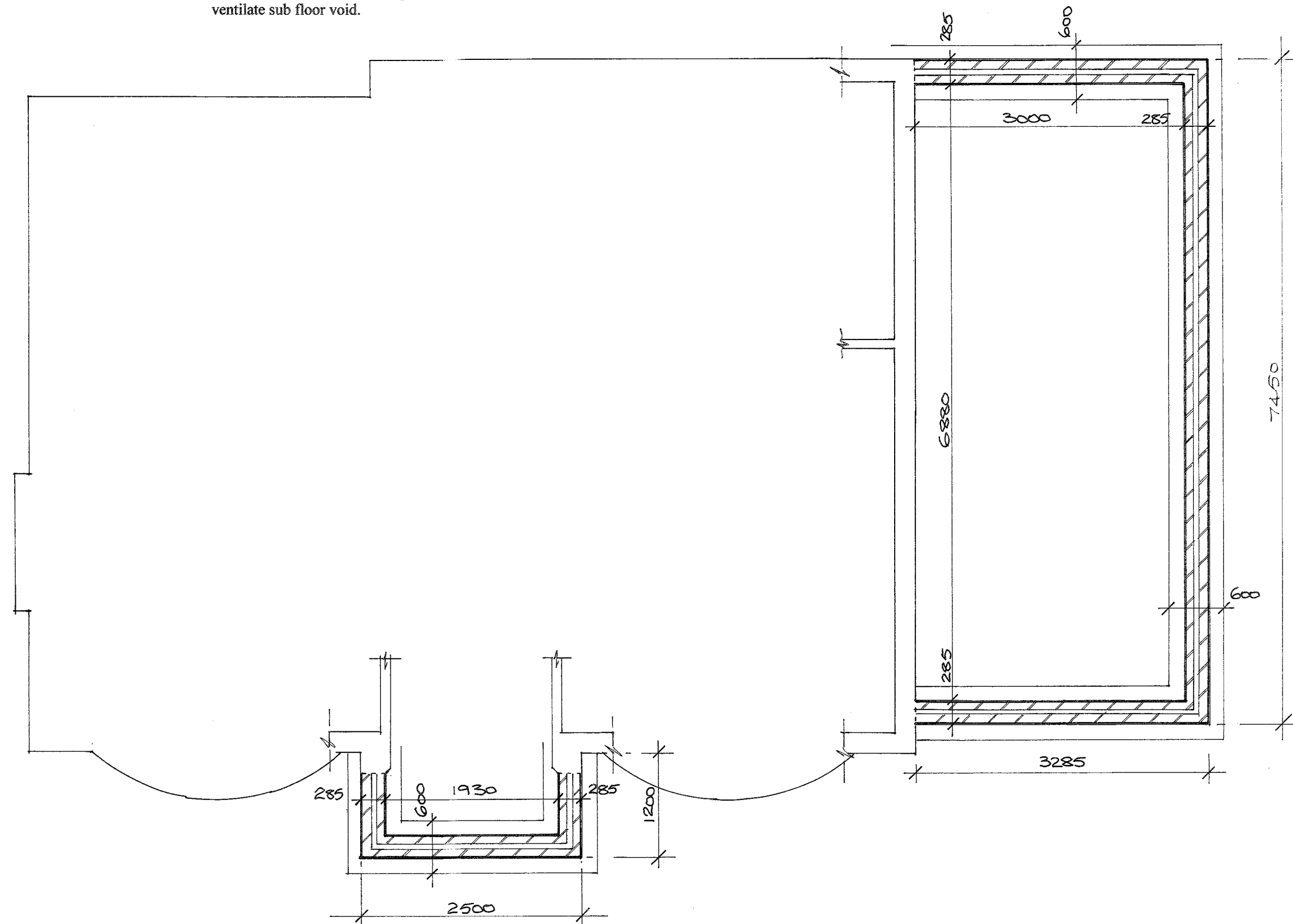

FOUNDATION PLAN

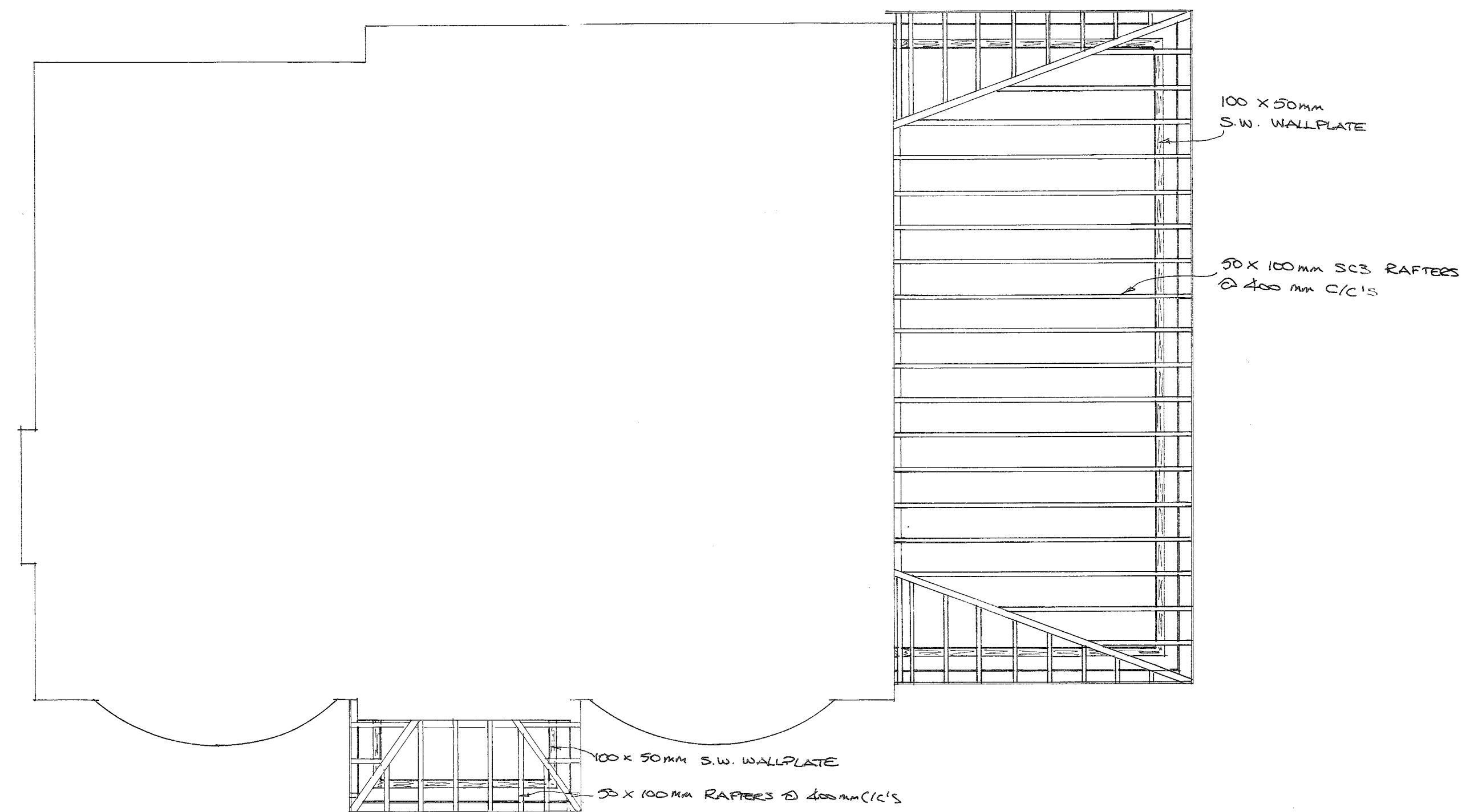

ROOF STRUCTURE PLAN (INDICATIVE ONLY)

The site copyright of this drawing is held by JANET TILLEY and none of the ideas, design or construction represented on it shall be used by or disclosed to any person, firm or corporation for any purpose without the written permission of JANET TILLEY.

THIS DRAWING IS THE PROPERTY OF JANET TILLEY
 DO NOT SCALE - USE FIGURED DIMENSIONS ONLY

REV DATE

janet tilley ARCHITECTS
 CONSULTANTS
 41 Monk Avenue
 Ramsgate
 Kent CT11 6JS
 01843 292917
 Mobile: 07781 761474
 MEMBER OF THE CHARTERED INSTITUTE OF ARCHITECTURAL TECHNOLOGISTS

DRAWING TITLE
 PROPOSED CONSTRUCTION DETAILS

CLIENT

JOB TITLE
 PROPOSED SINGLE STOREY SIDE EXTENSION
 & FRONT PORCH AT

DATE SCALE

DRAWING NO. REV